

DS-2CE56D5T-(A)VPIR3

HD1080P Outdoor Vandal Proof IR Dome Camera

TURBO HD

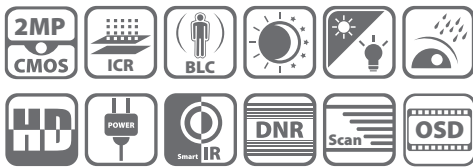

Key features

- 2 Megapixel high-performance CMOS
- Analog HD output, up to 1080P resolution
- 2.8 – 12mm vari-focal lens
- True Day/Night
- OSD menu, 3D DNR, Smart IR
- Up to 40m IR distance
- IP66 weatherproof & vandal proof
- UTC function(Pelco C protocol)
- 24V AC/ 12V DC (-A)

Dimensions

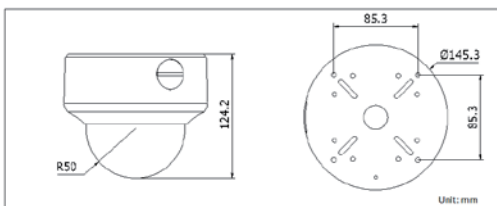

Accessories



Video balun
DS-1H18

Available models

- DS-2CE56D5T-AVPIR3
- DS-2CE56D5T-VPIR3

DS-2CE56D5T-(A)VPIR3	
Camera	
Image Sensor	2 MP CMOS Image Sensor
Signal System	PAL/NTSC
Effective Pixels	1920(H)*1080(V)
Min. Illumination	0.01 Lux @ (F1.2,AGC ON),0 Lux with IR 0.014 Lux @ (F1.4,AGC ON),0 Lux with IR
Shutter Time	1/25 s to 1/50,000 s
Lens	2.8-12mm @ F1.4 Angle of view: 103° - 32.1°
Lens Mount	φ14
Angle Adjustment	Pan: 0 - 355°, Tilt: 0 - 180°, Rotation: 0 - 355°
Day & Night	ICR
Synchronization	Internal synchronization
Video Frame Rate	1080p@25fps/1080p@30fps
HD Video Output	1 Analog HD output
CVBS Output	1Vp-p Composite Output(75Ω/BNC)
S/N Ratio	More than 52dB
Menu	
Scene	Indoor, Outdoor, Indoor1, LOW-LIGHT
Camera ID	On/off (15 characters, position programmable)
AGC	Support
D/N Mode	Color/BW/EXT
White Balance	ATW, AWC-SET, Indoor, Outdoor, Manual
Privacy Mask	On/Off, maximum 8 zones
Motion Detection	On/Off, maximum 4 zones
BLC	Support
Anti-flicker	On/off
Language	English, Japanese, CHN1, CHN2, Korean, German, French, Italian, Spanish, Polish, Russian, Portuguese, Dutch, Turkish, Hebrew and Arabic
Functions	Eclipse, Digital noise reduction, Digital zoom(62x), Slow shutter, Mirror, Defog, Defect pixel correction, SMART D-ZOOM
General	
Working Temperature/ Humidity	-30 °C - 60 °C (-22 °F - 140 °F) Humidity 90% or less (non-condensing)
Power Supply	12 VDC -A: 12 VDC, 24 VAC
Power Consumption	12V DC: Max. 4W 24V AC: Max. 5W
Weather Proof Ratings	IP66
IR Range	Up to 40m
Impact Protection	IK10
Communication	Up the coax(need UTC controller) Protocol: Pelco-C(Coaxitron)
Dimensions	Φ 145.3 × 124.2mm (Φ 5.72" × 4.89")
Weight	880g (1.95 lbs)